

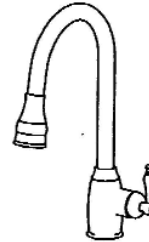

# Single Hole Kitchen Faucets KFS408, 409

## INSTALLATION INSTRUCTIONS

### Tools You Will Need:

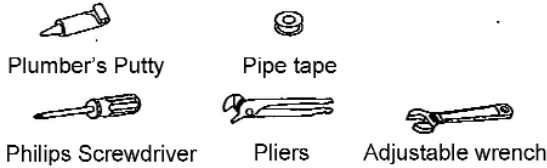

### Available Handle Options

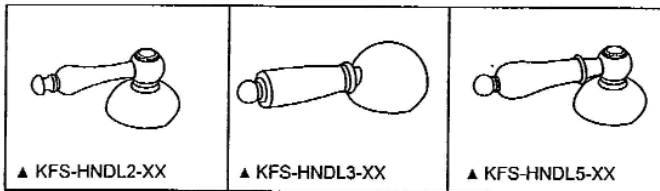

### Available Spray Options

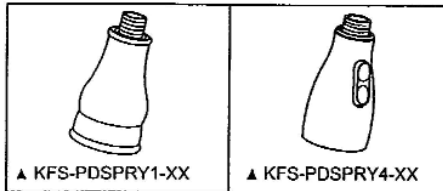

### INSTALLATION STEPS:

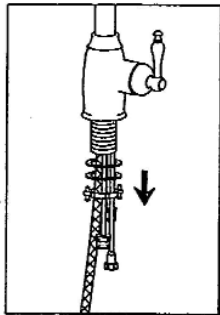

1. Remove the mounting hardware from the faucet

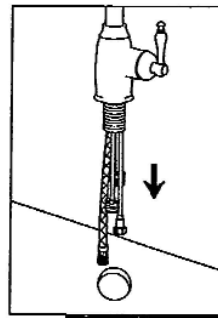

2. Install faucet through center hole.

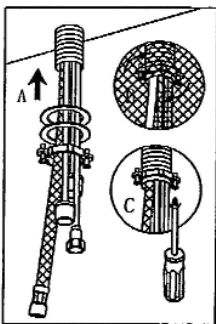

3. Re-assemble the mounting hardware onto the shank, use philips screwdriver for final tightening after spout is aligned.

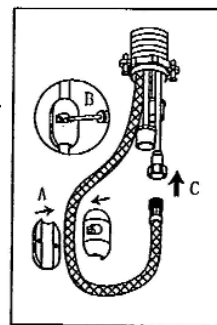

4. Proper installation of the hose weight kit will insure that the hand spray retracts smoothly. On the handspray side of the hose, measure 15" down from the body of the faucet. Install the hose weight kit at this point. Pull out on the handspray. It should move easily and retract smoothly. Reposition the hose weight kit as necessary. Make sure that the hot and cold supply hoses do not interfere with the handspray hose. They can be repositioned slightly if necessary.



# Single Hole Kitchen Faucets KFS408, 409

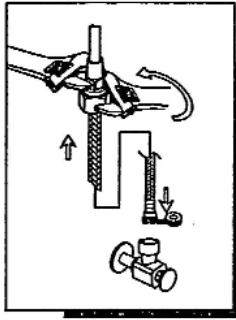

5. Attach water supply hose to the faucet. To avoid breaking the copper tube from the faucet, use two wrenches (as shown) to keep from the faucet when you tighten the nut, and attach the other end to the water supply.

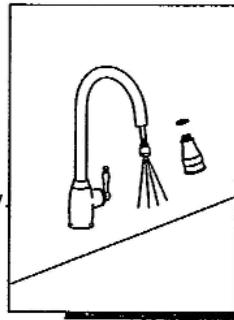

6. After installing faucet, remove spray assembly and open the hot and cold water supplies. Check for leaks. Turn on faucet handles for one minute to flush debris from faucet. Close the handles and re-assemble the spray.

## Exploded Drawing

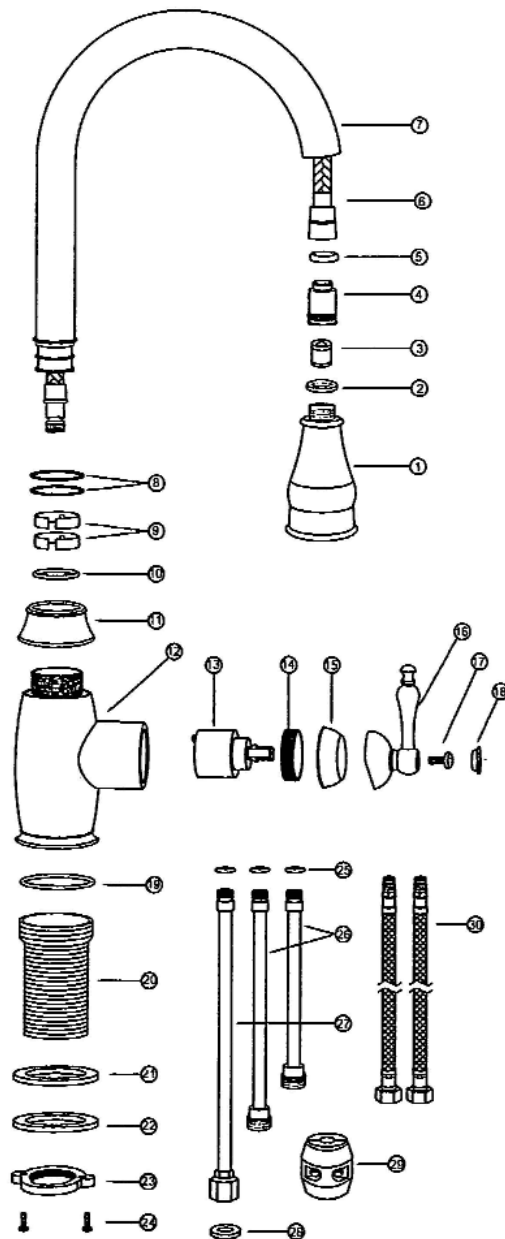

30	Water Supply Hose	2
29	Weight Kit	1
28	Gasket	1
27	Copper Tube-Out	1
26	Copper Tube-In	2
25	O-ring	3
24	Screw	2
23	Lock nut	1
22	Metal Washer	1
21	Rubber Gasket	1
20	Spout Shank	1
19	O-ring	1
18	Handle Cap	1
17	Screw	1
16	Handle	1
15	Trim Cap	1
14	Cartridge Nut	1
13	Cartridge	1
12	Cartridge Seat	1
11	Cartridge Seal Trim Ring	1
10	O-ring	1
9	Washer	2
8	Washer	2
7	Spout Assembly	1
6	Spray Hose	1
5	Magnet	1
4	Bushing	1
3	Check Valve	1
2	Gasket	1
1	Spray	1
No.	Part Description	Quantity